



Important!

Inspect ALL materials carefully BEFORE installation. Warranties DO NOT cover materials with visible defects once they are installed. It is the responsibility of the installer/owner to determine if the job site subfloor and job site conditions are environmentally and structurally acceptable for Grabo floor installation. The flooring manufacturer declines any responsibility for failure resulting from or connected with subfloor, subsurface, job site damage or deficiencies after SPC flooring has been installed.

General

Products with pre-attached underlayment; using additional underlayment will void the warranty and can cause excess deflection which will damage the locking joints. There is no laboratory testing data for sound reduction that supports use of additional acoustic underlayment to further reduce impact sound or sound transmission through the flooring. Products without foam backing we recommend Graborex underlayment to use. The product can be installed at temperature between 10 °C and 30 °C, and this temperature range should be kept after installation and during use as well. Relaxation / acclimation recommended 4-6 hours.

Usefull information

You should allow for 5 %-10 % additional square meter to account for cuttings

and waste. SPC planking is best when installed the length direction of the planks parallel to the main light direction. For floor surfaces exceeding 140m² and/or lengths exceeding 25 m, use expansion moldings at openings less than 2 m and increase expansion gaps to 10 mm.

In-floor radiant heat

This product can be installed over radiant heat concrete subfloors.

- » Electric and hydro systems are acceptable.
- » In-floor radiant components must be a minimum of 20 mm below flooring.
- » Floor surface temperature should never exceed 28 °C.
- » Heating system should be operational for at least weeks prior to installation to calibrate temperature settings.
- » Flooring cannot be laid directly over radiant heating mats!

Approved subfloors

Concrete, Plywood, OSB, Particleboard, Chipboard, Hardwood (Solid, Engineered, Parquet), Tile (Ceramic, Terrazzo, Stone, Asbestos, Peel and Stick), Fully Adhered Non-Cushion Sheet Vinyl
In case of tiles fill in grout lines larger than 4 mm on ceramic tiles, terrazzo, quarry tiles, and similar floors with a cementitious leveling and patching compound.

General requirements (all subfloors)

- » All subfloors should be flat to within 4 mm in 3 m.
- » Must be clean: no construction debris, soil, mud or any other objects on or adhering to the floor; if necessary, scrape and sweep away before the installation; no protrusions of nails, debris, or metals should remain.
- » Must be free from moisture-related conditions that can damage the installed flooring.
- » Be structurally sound without deflection.

Moisture content should meet one of the following criteria

- » **Cement based substrate:**
Subfloors with underfloor heating: < 1.8 CM%
Without underfloor heating: < 2.5 CM%
- » **Anhydrite-based substrate:**
Subfloors with underfloor heating: < 0.3 CM%
Without underfloor heating: < 0.5 CM%
- » **Wood based subfloors:** max. 14%

Existing floor coverings

- » SPC by Graboplast Ltd. can also be installed over most existing hard surface floor coverings provided that the existing floor is well bonded and the surface is flat and smooth.
- » Ceramic tile unevenness should be made smooth by applying an overlay such as cementitious patching or leveling compound.
- » Existing floors should not be heavily cushioned and not exceed one layer in thickness.
- » Do not install over carpet.
- » Floor should be flat, smooth, dimensionally sound and free from deflection.

Installation

SPC by Graboplast Ltd. is designed to be installed as a “floating” floor for indoor use only. Do not secure the planks to the subfloor. Always undercut wood doorjamb. Check local building code for metal door jamb. If they cannot be cut, then proper expansion must be maintained around door jamb. Use care when installing wall moldings and transition strips to not fasten through the product. SPC by Graboplast Ltd is a drop and lock product. Please see illustration below on proper install technique.

- » Begin laying planks from the left side of the starting wall and work to the right side. The tongue side of the plank shall face the starting wall.

- » Place a 5 mm spacer between the short/long side of the planks and the wall. Always position one spacer between the wall and where the planks join.

- » This SPC flooring is with drop lock on the short edges. You must always leave the grooves side of the short edge exposed for the next plank to be dropped into place. You cannot reverse the installation and must continue to start from the same side. Install one plank at a time, always leaving the exposed groove profile exposed to the end joint.

- » Installation the first row of the plank: lining the second plank with the first plank by push slightly toward and down on short edge.

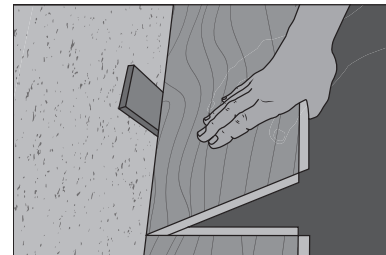
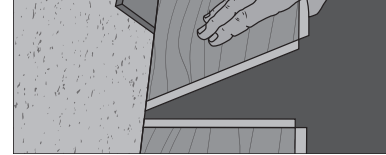
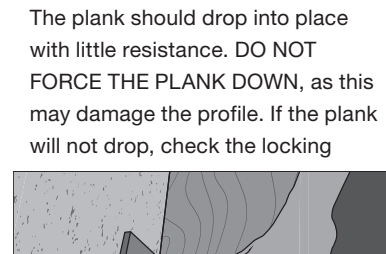
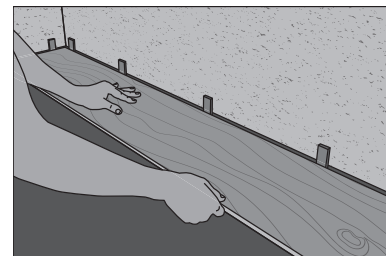

- » profile for debris or damage and retry. Please make sure that the planks are perfectly aligned. Install remaining full planks in the first row.

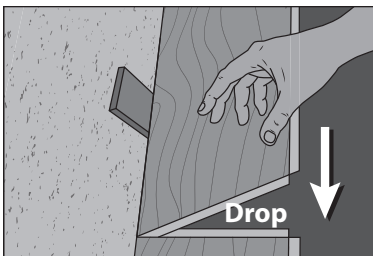

- » The last plank in the first row will need to be cut. Measure the distance between the wall and the surface of the last full plank. If the length is smaller than 25 cm, the length of the first plank in the row must be cut. The first and last plank in each row must be at least 25 cm in length. Planks are cut using jig saw or a hand saw, chop saw or guillotine cutter.

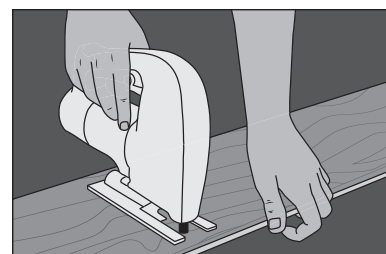
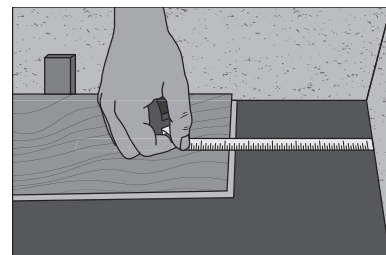

- » The remaining piece cut off from the last plank in the first row may serve as the first plank in the second row provided it is at least 25 cm long. Always stagger end joints from row to row a minimum of 25 cm apart.

- » Install the long side of the first plank of the second row. Remember to

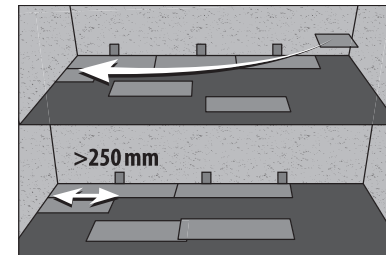

- » place a 5mm spacer between the wall and the short side of the plank. Insert the tongue side into the groove side of the previous row at a low angle and lower flat to the substrate.

- » Attach the second panel of the new row first on the long side. Tilt and slide

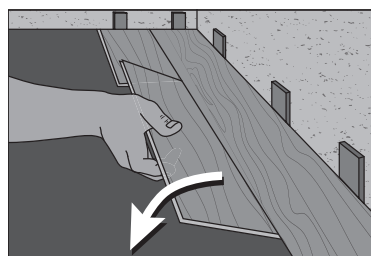

this panel as close as possible to the previous row and then drop the profile into the lower panel groove.

- » Using rubber mallet gently tap the upper panel to make sure it clicks.
- » After all planks have been installed, remove spacer from perimeter of room.

After installation: Install transition moldings, skirtings. Do not press the moulding or trim down too hard, otherwise the floor may become trapped or start to creak. For the same reason mouldings and trims should not be glued, screwed or nailed into or through the floor. The finished floor can be used immediately after the job is done. Underfloor heating can be restarted, however gradually increase the temperature over a number of days by only a few degrees per day (+5 °C/ day) until the desired room temperature is reached.

Disassembling

Your floor can very easy be disassembled, which enables replacement during installation and also during use. Separate the whole row by carefully lifting up and

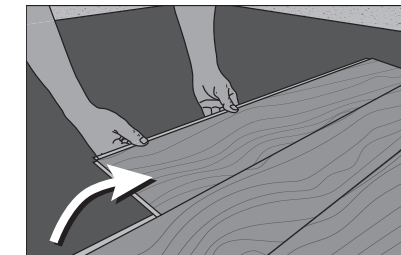

slightly knocking just above the joint. Fold up and release the whole long side. Disassemble the panels by sliding horizontally. (Do not fold up!)

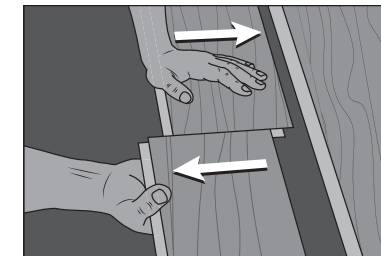

Cleaning and maintenance

After installation make a thorough cleaning. To maintain the aesthetic floor surface, we recommend regular cleaning. Remove solid impurities by sweeping or vacuum cleaner, then make wet cleaning with a well-wrung mop or microfiber mop. Use pH-neutral detergent or alcoholic cleaning agent suitable for plastic floors. Use scrubbing brush to remove stubborn dirt. Do not use aggressive or abrasive cleaners. Furniture should be moved using an appliance hand truck over hardboard runways. Heavy furniture should be equipped with suitable non-staining, wide-bearing casters or protectors. Non-staining felt protectors are recommended for table and chair legs to help prevent scratching.

